



## Plan View

Seating Capacity is approximately 30 students for instruction; 60-65 additional supplemental seating.

Volume Capacity is 579 linear feet at 20 volumes for linear foot = 11,580 books

## Circulation

The Nomad mobile circulation desk solution is the perfect choice for media centers who need unmatched flexibility and adaptability. Desk can plug in like a household appliance by way of wire management and power module to go with you wherever you go. With a compatible book cart to maintain check-ins and making reshelfing a cinch.



## Instruction

Bola seating for 30 and crescent shape tables offer big gains with large elementary classes. The crescent shape delivers a natural 2-1 approach making engagement with little ones that much easier when working across the table.

*Color choices available upon request.*



## Breakouts

Larger breakout areas offer another place for instruction to commence. Impromptu ottomans on glides offer controlled movement while be appropriate in height to marry to a table or as a stand-alone seat when collaborating

## Mobile Storage

Mobile book browsers store approximately 250 books each. Heavy duty casters offer easy mobility allowing for them to be parked or move freely throughout the space. Browsers are a perfect way to present books to younger students in an appealing manner (cover facing)



## Storytime and Lego Wall:

Building with LEGOs provides both individuals and groups opportunities to develop social, problem-solving, organizational and planning skills by constructing three dimensional "pictures" on a wall of endless possibilities. Ad lib tiered seating provides greater seating density for story time nooks.

*Color choices available upon request.*



## 2D Plan View

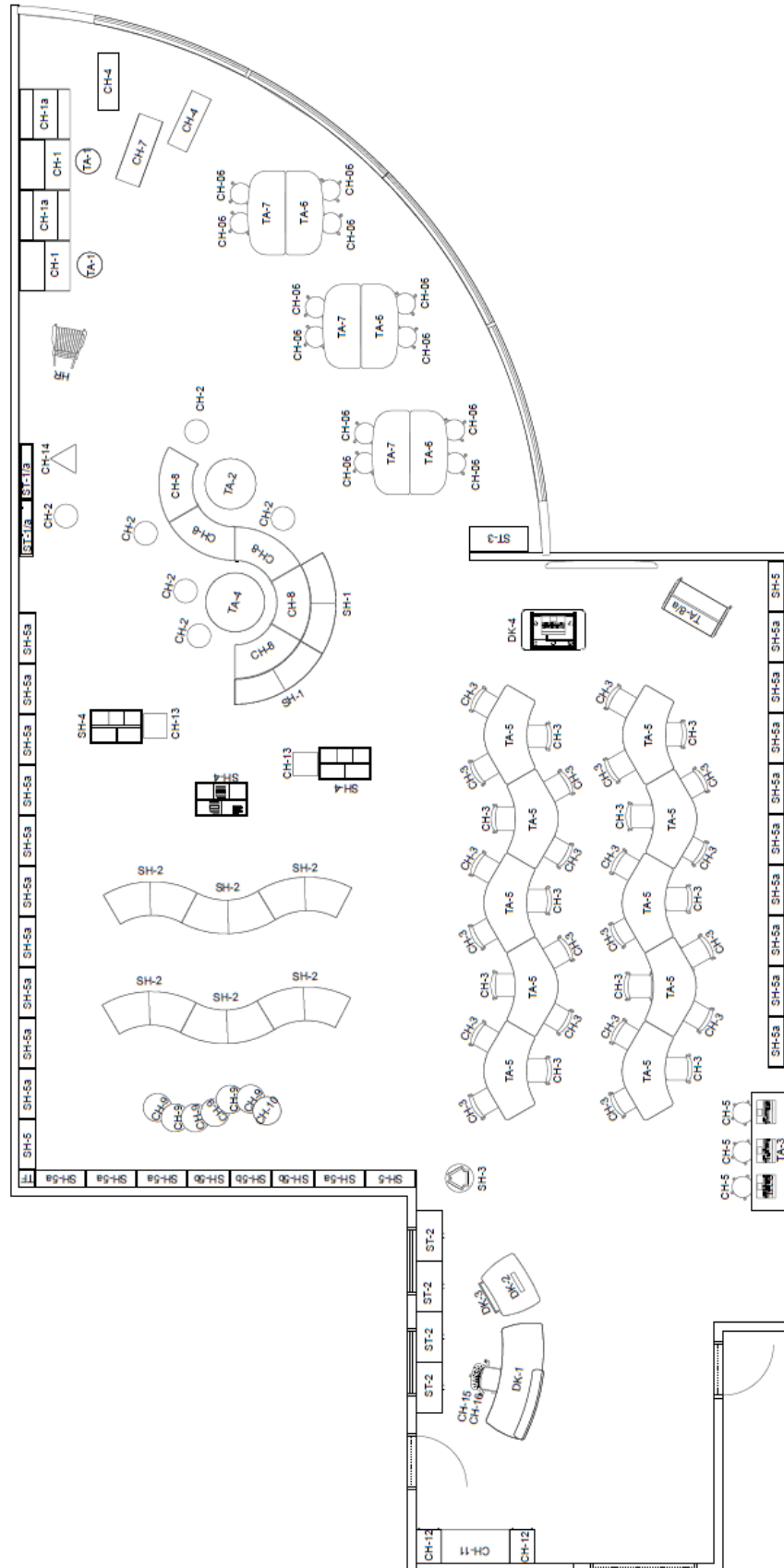

*Color choices available upon request.*

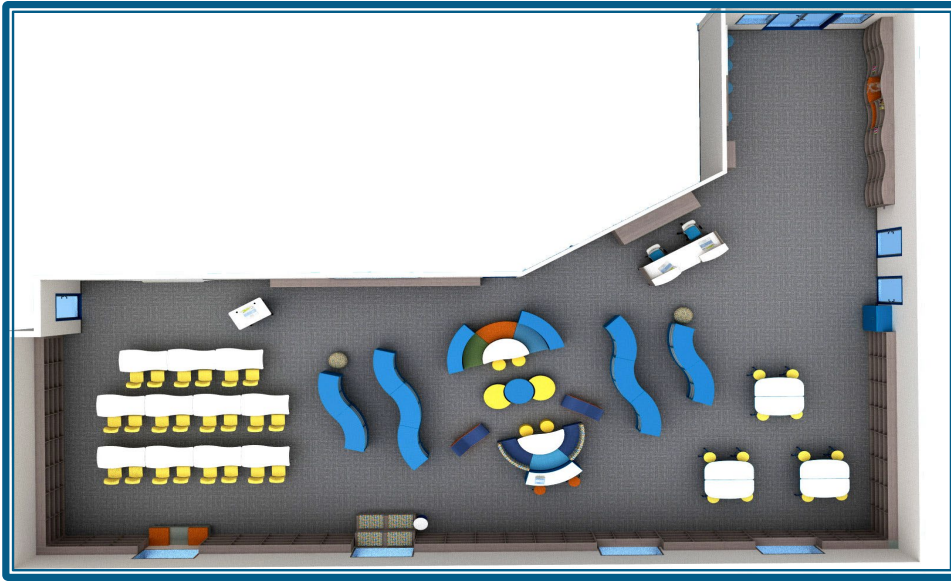

### Plan View

Seating Capacity is approximately 25 students for instruction; 53-55 additional supplemental seating.

Volume Capacity is 853 linear feet at 18 volumes per linear foot = 15,354 books.

## Circulation

The mobile Interact circulation desk grants 2 teacher librarians' ample personal storage and workspace for checking students in and out. The mobile base means additional flexibility often lost with traditional casework. Drift mobile storage credenza offers additional concealed storage for day-to-day activities.



## Computer Look Up

The WCT table is a workhorse capable of managing wires and cables for computer look up stations, self check in/out or project work. The integrated wire management provides easy access to cabling for troubleshooting an issue. Optional paneled leg provides a built-in aesthetic.

***Color choices available upon request.***





## Breakouts

Breakouts for teenagers must be comfortable for all shapes and sizes, inspiring and provide adaptability for small and large group activities. This combination provides it all....high top tables, standard height tables, large and small ottomans, booths, benches, and Fred lounge seating. The combined solution promotes a relaxed approach to learning – which studies suggest is the most successful approach with this age group leading to cooperative work in a more natural way.

## Makerspaces

Work+box dock tables provide a unique pod for makerspaces within the media center. Docks utilize industrial magnets when forming a large solid worksurface for bigger group work as well as the ability to break into smaller group stations when pulled apart. Undersurface storage options include concealed, open or tote providing additional flexibility by way of products being stored.



## Storage Benches

Our newly enhanced Ad Lib tiered seating, is the perfect story time nook, nestled between perimeter shelving. The new HPL construction with field replaceable seat pad, allows for greater seating density between the stacks and options to replace damaged or dated cushioning once the time comes for something new.

*Color choices available upon request.*





### Transition

Transition, our patented track-mounted shelving solution, offers a unique alternative to traditional bookcases in an area typically reserved for transitional book display.

Transition's open shelving construction offers optional cabinet doors, visual communication and/or acoustical panels as well as seating in both TFL and HPL. We have included an optional double bench seat. This inclusive design solution offers an optional single or double bench application by way of a removable shelf and seat pad – serving as the perfect cozy spot for students needing a quiet area to work, read or regroup.

Transition open back shelving provides easy access to power and otherwise underutilized space between casework and the floor. The 6-inch clearance achieved by hanging cabinetry off the floor, provides a unique storage advantage as well as flooring access for remodels.

Ships knocked down.

***Color choices available upon request.***

## 2D Plan View

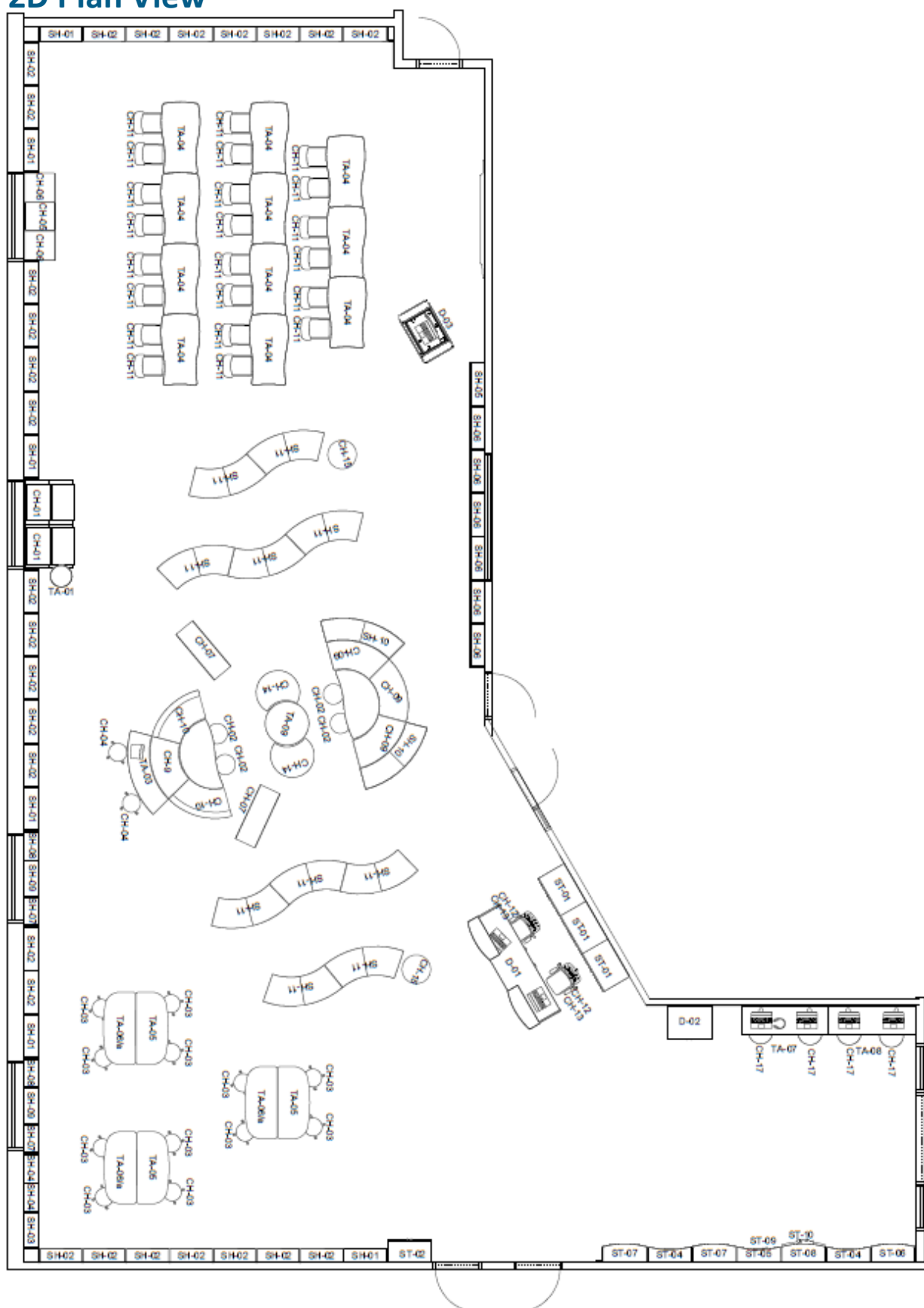

***Color choices available upon request.***





## Plan View

Seating Capacity is approximately 40 students for instruction; 57-60 additional supplemental seating.

Volume Capacity is 657 linear feet at 15 volumes per linear foot = 9,855 books.

## Small Breakout

Mobile breakout spaces allow for ultimate flexibility when hosting large faculty meetings, professional development, book fairs and guest speaking engagements.



## Independent

Specifying 18in. seat height for soft seating solutions allows for greater flexibility when pairing tables with seats for writing or working on devices. Our Forum worktables offer individual surfaces throughout the space for spontaneous teamwork and meetups.

*Color choices available upon request.*





### Media Sharing

#### Circulation and Touchdown

Media Centers should offer students a variety of ways to work independently or as a group. Computer tables serve as both a place for project work, look up stations or self-check. Lounge chairs, bench seating, wobble stools and booths provide numerous seating styles for instruction, reflection, small/large faculty meetings, student group work or independent study.



*Color choices available upon request.*

## 2D Plan View

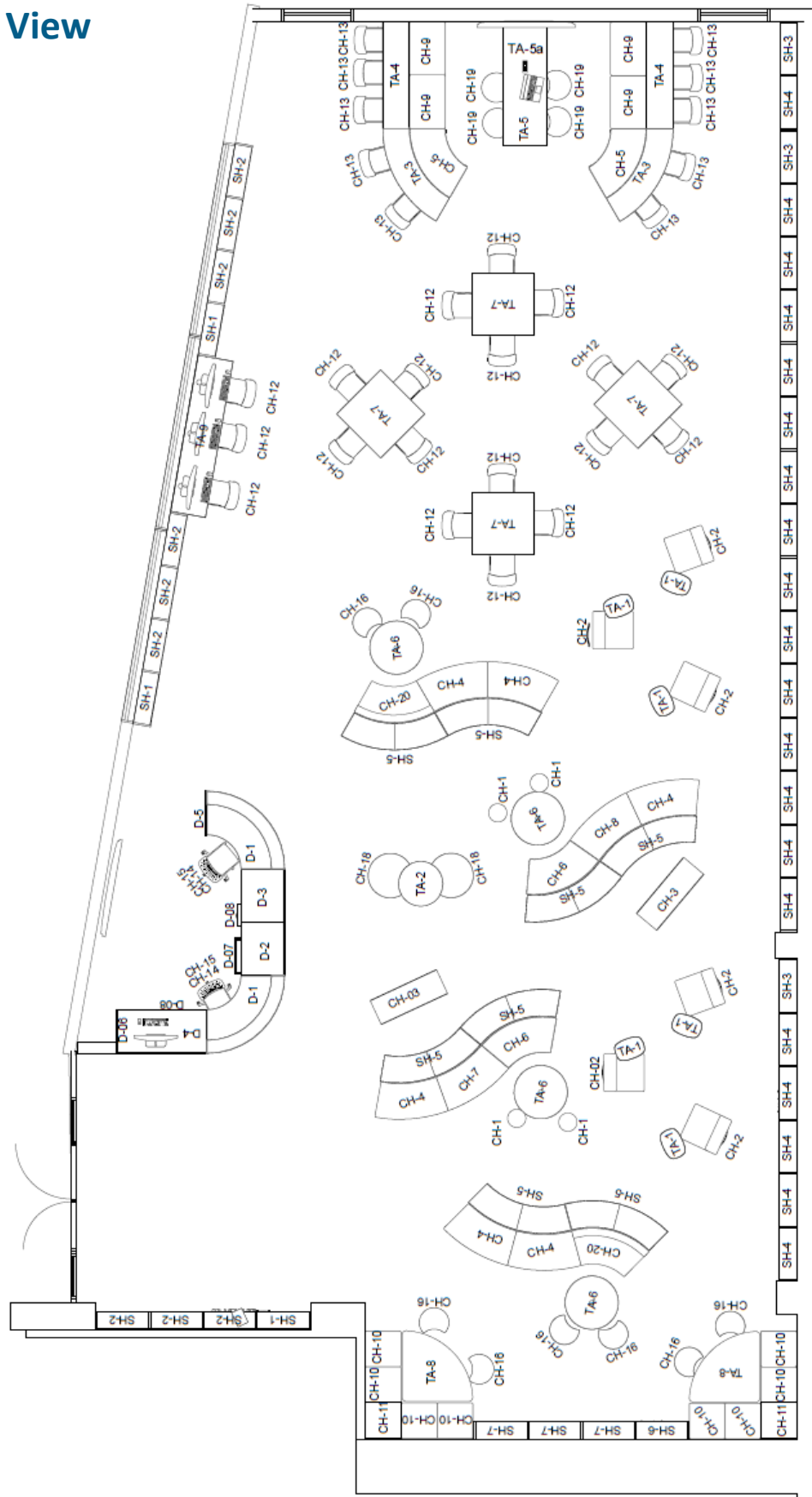

*Color choices available upon request.*





*Color choices available upon request.*



*Color choices available upon request.*





*Color choices available upon request.*